



# Model X

## Single leverage Arbor Press Instruction and Parts list

<u>Item</u>	<u>Part Name</u>	<u>Part Number</u>
1	Handle	110
2	Retaining ring (National lock washer number XRC-327)	43965
3	3/8"-16 x 3/4" thumb screw	43622
4	Spindle	111
5	Retaining ring	67424
6	Ram (1" x 1" x 7 5/8") <i>Frame is showing a breakaway view.</i>	109
7	3/8"-16 x 5/8" stainless set screw	43589
8	Brake spring	108
9	Tinners rivet	43577
10	Ram cap	103
11	1/4"-20 x 3/4" hex cap screw	43304
12	Ram cap shims (.008")	106
13	Ram cap shims (.015")	107
14	Frame	14310

***Please contact factory for current prices.***

**Ordering information:** Please order all repair parts by part number and name, also mention model number of press. All parts are shipped F.O.B. Factory in Grand Haven, MI.

**Lubrication:** Keep all working parts of the press well oiled for easier operation. Also keep a light film of oil over the entire surface of the ram to prevent rust.

### **DAKE**

Division of JSJ Corp.  
724 Robbins Road  
Grand Haven, MI 49417

Phone: 616-842-7110 800-937-3253  
Fax: 616-842-0859 800-846-3253  
E-Mail: customerservice@dakecorp.com  
technicalservice@dakecorp.com  
Website: www.dakecorp.com

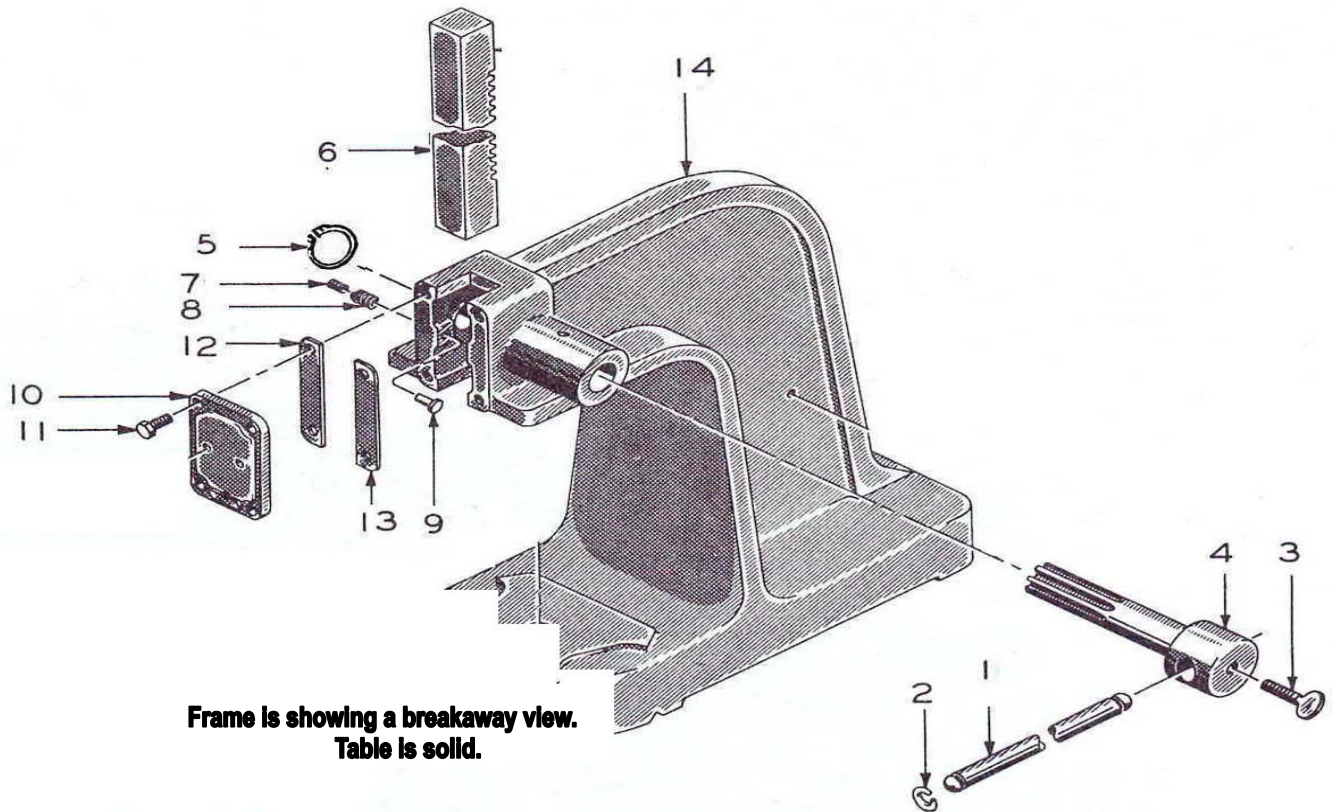

Frame is showing a breakaway view.  
Table is solid.



## SAFETY

**This is the safety alert symbol.** When you see this symbol on your press, be alert to the potential for personal injury.

### Follow recommended precautions and safe operating practices.

**Carefully read all safety messages in these instructions and on your press safety signs.** Keep safety labels in good condition. Replace missing or damaged safety labels.

**This machine is intended to be operated by one person.** This person should be conscious of the press ram movement not only for themselves but also for persons in the immediate area of the machine.

**Under no circumstances increase the leverage ratio of the press by using a longer handle or by placing a pipe over the handle.** Never hammer on top of the ram.